



QUICK START GUIDE



**INSTRUCTION MANUAL AVAILABLE AT:
www.LiteratiReader.com/support**

Literati™ WIRELESS READER QUICK START GUIDE



1

Included Accessories

Literati Wireless Reader
Power adapter
USB cable
Manual

Supported Operating Systems

Microsoft Windows® 2000
Microsoft Windows® Vista

Microsoft Windows® XP
Apple Mac OS® X 10.4x

SD Card Storage: Adds storage capacity using an optional (not included) SD Memory Card (up to 8 GB).

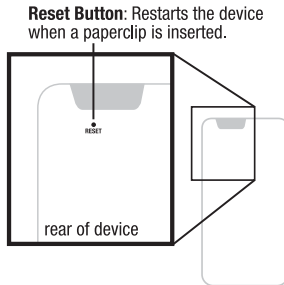

Display: Adjust the brightness, font, and font size. Also, choose the display format of the Books/Library tab.

USB Port: Transfers eBooks to your Literati Wireless Reader.

Power Jack: For charging Literati Wireless Reader.

CAPS-Lock: Toggles the keyboard between lowercase and uppercase typing.

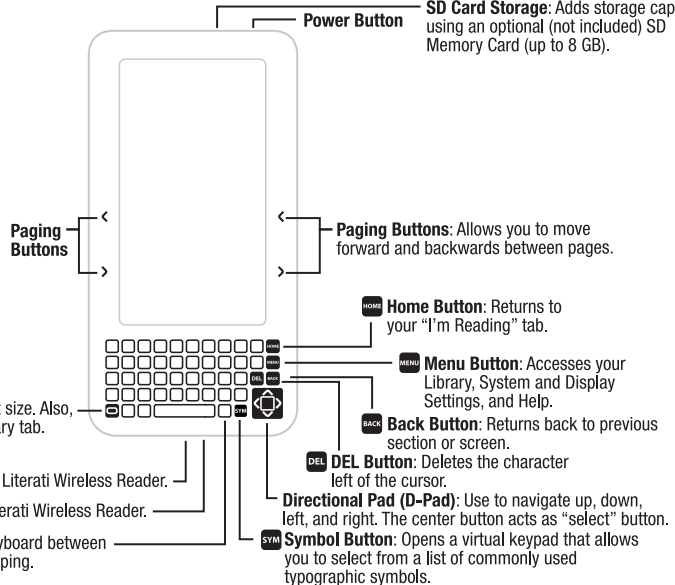



② INTRO TO WIFI

WIFI NETWORKING

Your Literati comes with a built-in bookstore with access to over two million titles. In order to access the bookstore, you will need to connect your Literati to a wireless network.

- ① Press the “menu” button and then use the Directional Pad (D-Pad)  to click on “Wi-Fi”.
- ② Click on “Enable”.
- ③ A list of detectable wireless networks will appear.
- ④ If you choose a secure network, enter your password, then click “Join”.
- ⑤ At this point you may be prompted to update your Literati. Please see page 7 of this guide for more details on updating your Literati.
- ⑥ Additional details on WiFi settings can be found in the instruction manual.

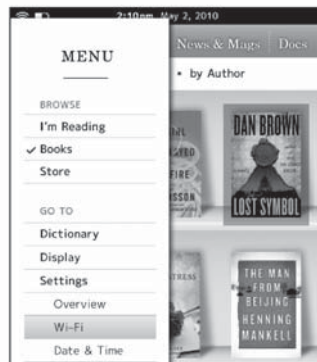

Please Note: The device will automatically disable WiFi when the battery reaches 25%.



3 BUILT-IN BOOKSTORE

1 Click on the home button and navigate to the “Store” tab.

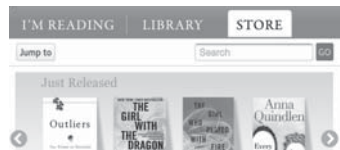

2 If you are not connected to WiFi, you will be prompted to connect. See page 3 for more details.

3 Search for a title and follow instructions to buy!

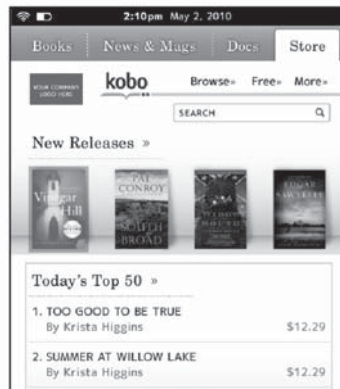

4 If you have not set up an account, you will be prompted to do so.



4 CREATE A BOOKSTORE ACCOUNT

With your Literati, you can access one of the world's largest online bookstores, Powered by Kobo Books. To download or purchase books from Kobo, you will need to create an account. Once created, your account will allow one-click purchases.

- 1 When trying to buy your first book or sync your device, you will be prompted to Log In. If you have already created a Kobo account, enter it now and click **SIGN IN**



- 2 If you have not created an account, click **GET STARTED**

- 3 Now that you are signed in, you may sync your device with any previous purchases by clicking on the sync button . This can be found in the "I'm Reading" or "Books"/"Library" tab.

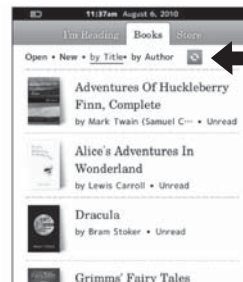

← Sync button



5 READ

- 1 You can access your titles from two different tabs on your Literati. The “I’m Reading” tab shows you a list of the books you have begun reading. The “Books”/“Library” tab shows your purchased and free titles. On either tab, selecting a book will open it for reading.

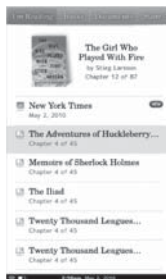

- 2 As you read, use the following buttons:
 - Paging Buttons < > - Use these to move to the next or previous page. You can also use the Left and Right buttons on the D-Pad.
 - Display Button - this button allows you to change the typeface and size of the font. (You can also use the Up/Down buttons on the D-pad to change the type size).

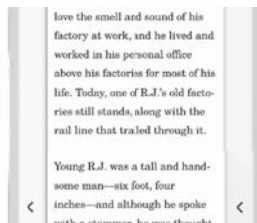



6 UPDATING YOUR LITERATI

The Sharper Image® is dedicated to ensuring that you enjoy your Literati for years to come. As we develop new enhancements and features, your Literati will automatically prompt you to update when you connect to a wireless network.

To update your Literati:

- 1 Connect to a wireless network. See page 3 for more details. Your Literati will automatically check to see whether an update is available. If an update is available, your Literati will notify you and prompt you to update.
- 2 Click OK to begin the update process.
- 3 When your Literati prompts you to finish the update, click Restart. The update will take effect after your Literati restarts.



INSTRUCTION MANUAL
A downloadable instruction manual is available at:
www.LiteratiReader.com/support

FOR TECHNICAL SUPPORT CALL
(866) 204-4714

RECYCLING PROGRAM

Certain components from your Literati should be recycled rather than disposed of in the trash in order to protect the environment and comply with certain state laws. When you are prepared to dispose of your Literati, please contact us so that we can arrange to recycle your Literati for you.

Call us toll-free to participate: (800) 374-2744



This device complies with Part 15 of the FCC Rules. Operation is subject to the following two conditions: (1) This device may not cause harmful interference, and (2) this device must accept any interference received, including interference that may cause undesired operation.

FCC NOTE: The manufacturer is not responsible for any radio or TV interference caused by unauthorized modifications to this equipment. Such modifications could void the user's authority to operate the equipment.

For technical support, please visit www.LiteratiReader.com or call (866) 204-4714

©2010 Sharper Image Acquisition, LLC. All rights reserved.

©2010 MerchSource, LLC. All rights reserved.

THE SHARPER IMAGE® name and logo are registered trademarks of Sharper Image Acquisition, LLC used under license by MerchSource, LLC. All other logos and trademarks are proprietary to their respective owners.

The artwork and design of this manual are protected by US copyright law and may not be reproduced, distributed, displaced, published or used for any purpose without prior written permission. Altering, removing or reproducing any of the trademark or copyright notice forms on this manual is not permitted.

The Literati name and logo are trademarks of MerchSource, LLC.

Kobo, kobobooks.com and related logos are trademarks and the property of Kobo Inc.

Other names and content are the property of their respective owners.

Distributed by MerchSource, LLC, Foothill Ranch, CA 92610. PATENTS PENDING

Printed in China